

Installation - Aqualine Gutter and Bracket Preparation

Aqualine gutter systems are supported on concealed bracketry which requires pre-painted fascia boards to be straight and level. The use of shims provided in the Aqualine Starter Packs assists bracket alignment and improves gutter connections whilst minimising stress within the joints. As a guide there are 4 brackets per 3 metre gutter length. Position angles using 2 brackets per angle, inset 150mm from each open end. Position outlets using 1 bracket inset 75mm from open end. At gutter ends where no outlet exists, position 1 bracket inset 150mm.

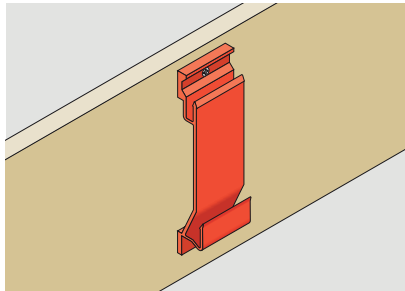

Bracket for Half Round and Deep Run gutters.

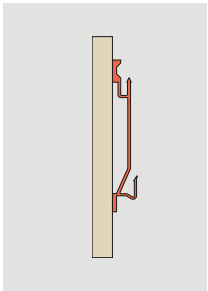
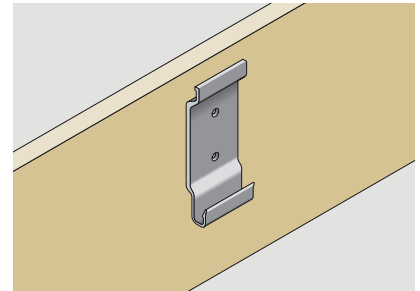
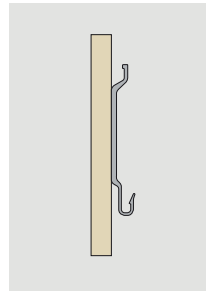

Bracket for Modern, Moulded and Box gutters.

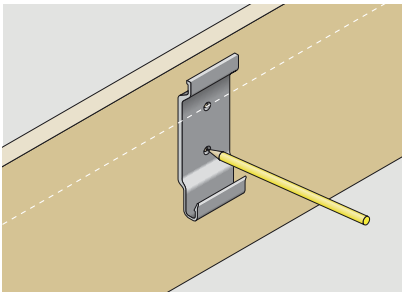

1. Use a string line or laser to set out brackets. (Aqualine must be laid level).

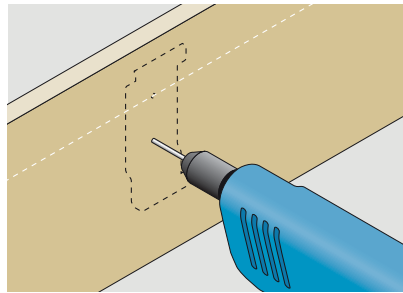

2. Position and pilot 3.5mm diameter hole.

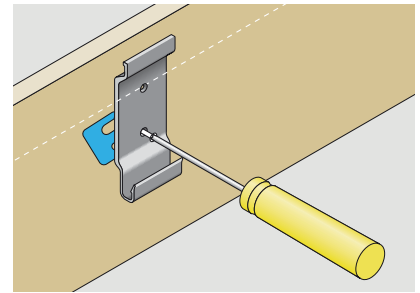

3. Lightly tighten and shim if necessary to align plumb. Fix using No12 x 38mm roundhead screws.

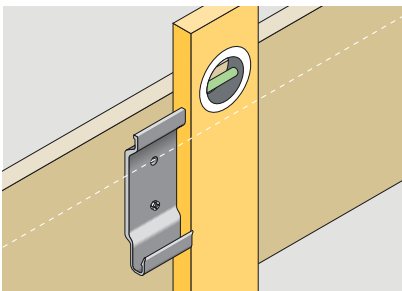

4. Set square.

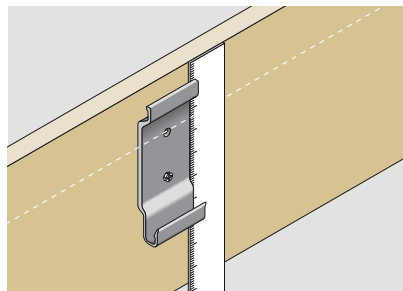

5. Check positioning and adjust if necessary.

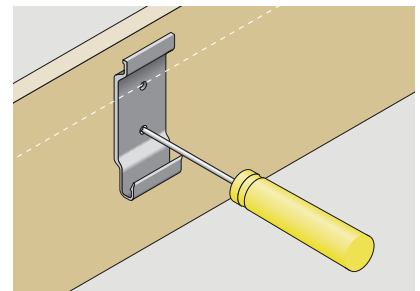

6. Tighten.

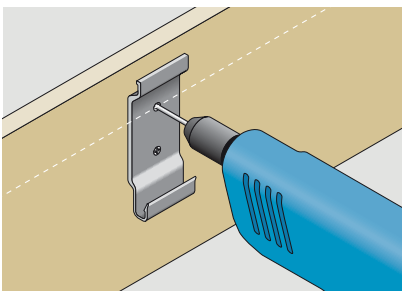

7. Pilot 3.5mm diameter hole.

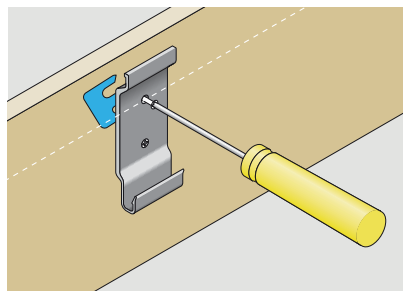

8. Check for plumb, shim if necessary and tighten.

Installation - Aqualine Half Round, Deep Run and Modern Gutters

Aqualine Half Round, Deep Run and Modern gutters use a unique dry jointing system to give a completely clean external appearance. Gutters drop and lock onto concealed brackets where internal joints are aligned and locked using slide bars. Assembly of Half Round, Deep Run and Modern gutters requires the use of single front lock bars. The entire gutter system is completely secure whilst at the same time allowing free linear thermal movement.

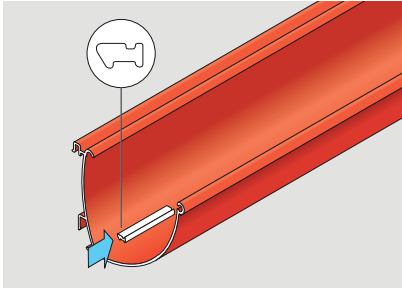

1. Pre-insert slide lock bars (1 per joint). Check for right way up.

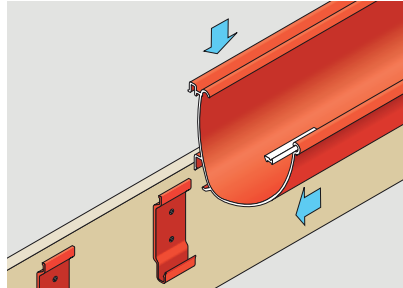

2. Position gutters loosely, do not lock down.

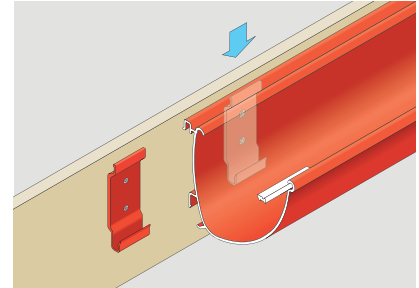

3. Locate gutters onto top rail of brackets and allow 4mm gap.

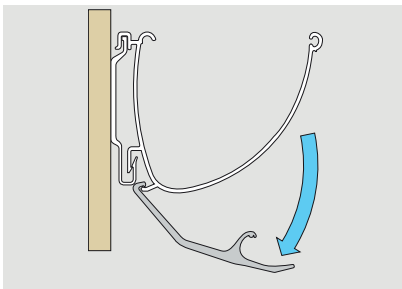

4. Lock down gutter with Aqualine jointing tool.

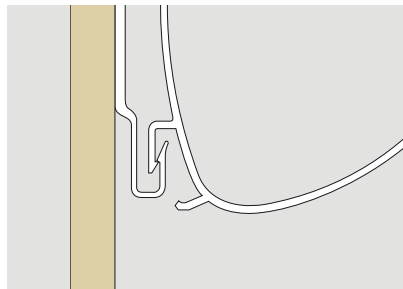

5. Check for positive location.

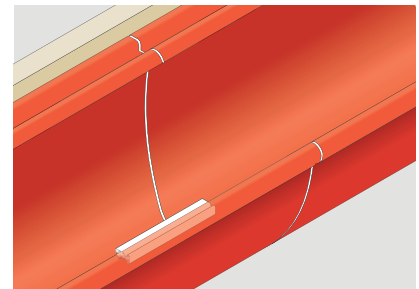

6. Slide lock bar within 50mm of joint but NOT across gutter joint.

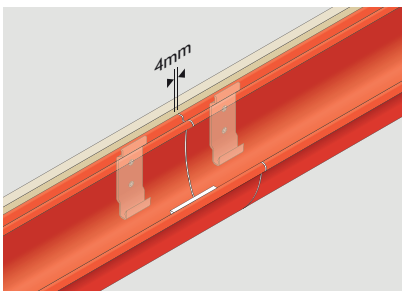

7. Check and reset 4mm expansion gap as necessary.

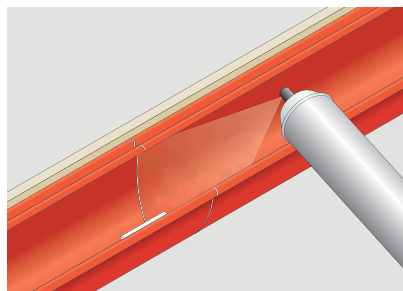

8. Clean jointing surfaces and spray apply Alumasc lubricant.

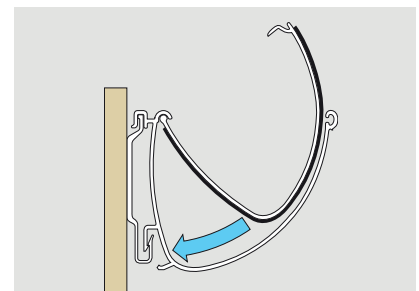

9. Hook joint union into gutter receiver channel and pivot down.

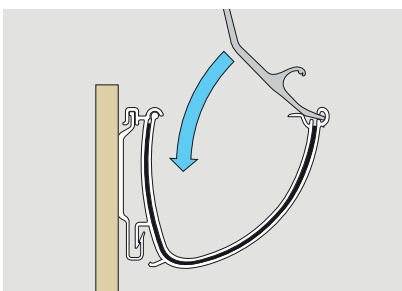

10. Compress joint union and start lock bar across joint.

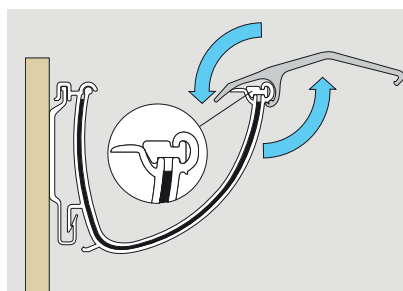

11. Reverse tool apply **equal** pressure around **pivot** point to complete lock bar positioning fully across joint. Take care not to dislodge gutter from fascia bracket.

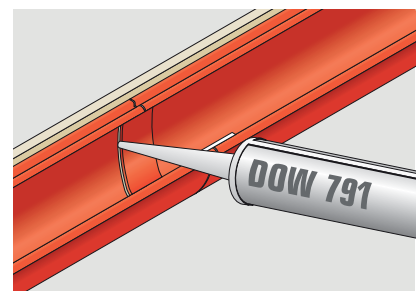

12. Dry gutter and apply DOW 791 silicone sealant to weather edges of union.

Installation - Aqualine Moulded and Box Gutters

Aqualine Moulded and Box gutters use a unique dry jointing system to give a completely clean external appearance. Gutters drop and lock onto concealed brackets where internal joints are aligned and locked using slide bars. Assembly of Moulded and Box gutters requires the use of lock bars located at the front and rear. The entire gutter system is completely secure whilst at the same time allowing free linear thermal movement.

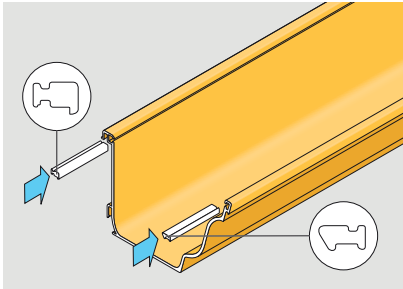

1. Pre-insert slide lock bars front and rear. Check for right way up.

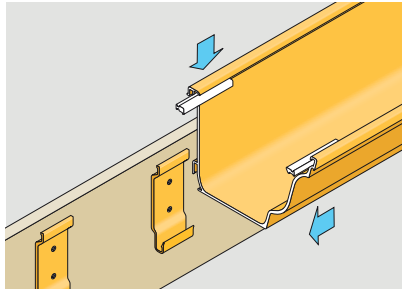

2. Position gutters loosely, do not lock down.

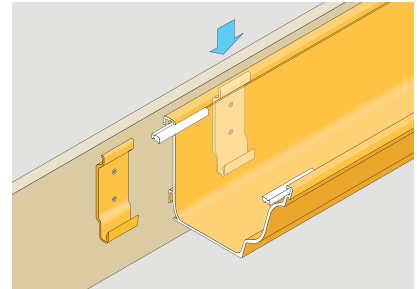

3. Locate gutters onto top rail of brackets and allow 4mm gap.

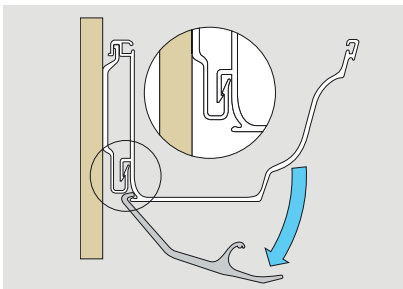

4. Lock down gutter with Aqualine jointing tool and check for full location.

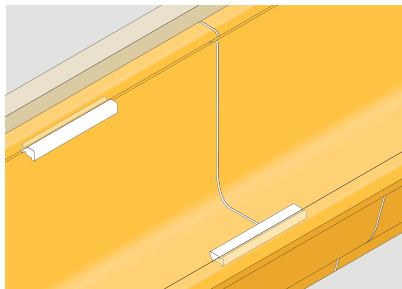

5. Slide lock bars up to but NOT across gutter joint.

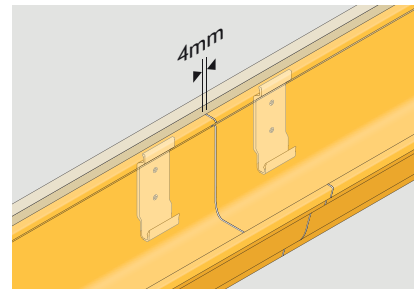

6. Check and reset 4mm expansion gap as necessary.

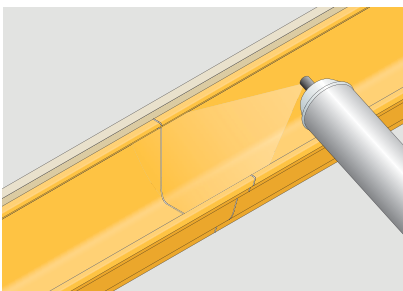

7. Clean jointing surfaces and spray apply Alumasc lubricant.

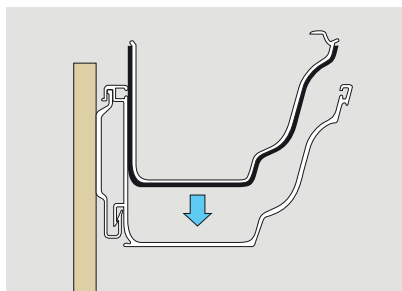

8. Push in joint union from above.

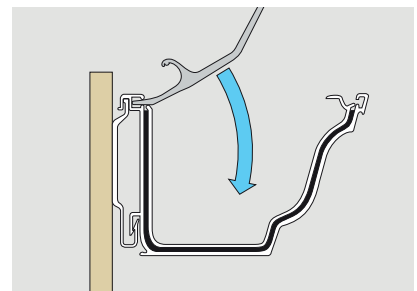

9. Compress joint union (back) and slide rear lock bar fully across joint.

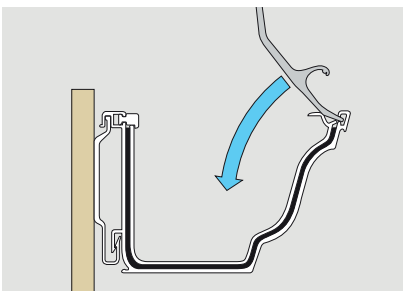

10. Compress joint union (front) and start front lock bar across joint.

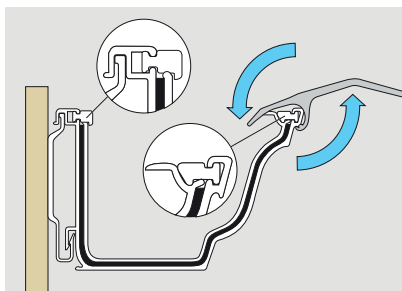

11. Reverse tool apply equal pressure around pivot point to complete lock bar positioning fully across joint. Take care not to dislodge gutter from fascia bracket.

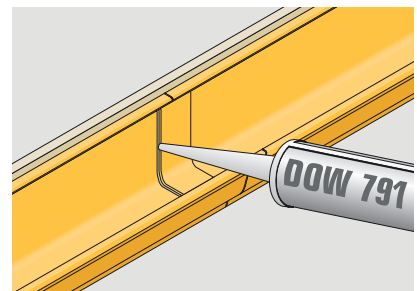

12. Dry gutter and apply DOW 791 silicone sealant to weather edges of union.