

**SnapIT aluminium rainwater system**

Rainclear’s SnapIT aluminium rainwater system joins together using concealed internal joints which give a smooth, clean appearance and is ideal for contemporary building design. The range consists of the three gutter profiles most commonly installed in the British Isles, half round, vintage moulded ogee and box profile. The gutter system is complimented by a swaged round pipe system in 76mm diameter.

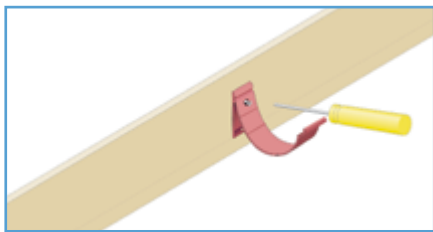

1. Set out the required gutter position and outlets to fall. Fixing method will vary dependant on site detailing. Fascia brackets are commonly used, alternative brackets are also available e.g. rise & fall and rafter brackets.

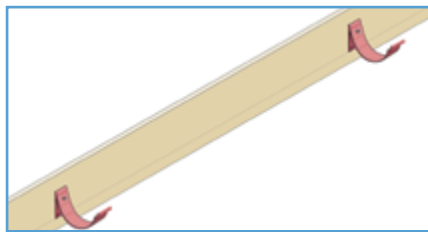

2. Position brackets at 750mm centres making sure that the first bracket is a maximum of 375mm from the end of the gutter. Allow for 1 bracket per outlet and angle. Fix fascia brackets using No12 x 1.5" (Product code: COUNT15) countersunk screws.

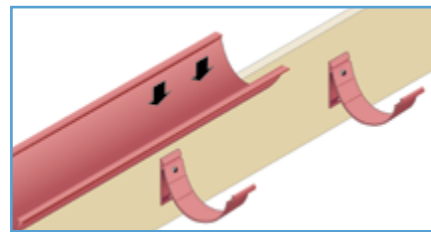

3. Locate gutters into the brackets and allow 4mm expansion gap. Clip the gutters into position making sure that the gutter is securely fixed into the bracket.

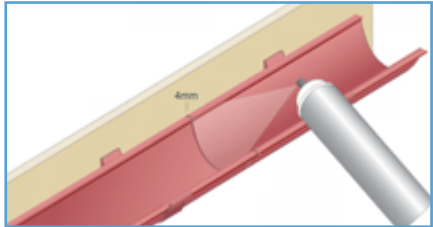

4. Degrease the jointing surfaces using Rainclear solvent cleaner (Product code: SOLCLEN).

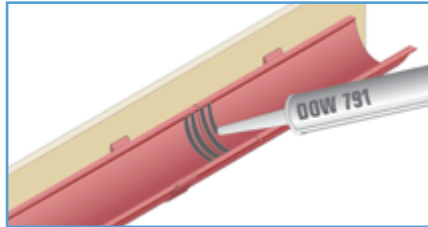

5. Apply two 6mm beads of low modulus silicone sealant to each gutter end. These should be located within the 38mm sealing zone as shown. Rainclear recommends the use of DOW791 (Product Code 791BLACK).

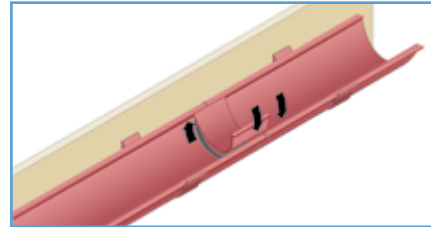

6. Offer the union into position. With the back edge in the locking position, pivot the union in to position by carefully pressing in to the sealant and clipping the front edge into place.



7. Seal both edges of the union with low modulus silicone sealant DOW791, removing any excess. All cut edges must be re-coated using Touch-up paint (available in 250ml tins).

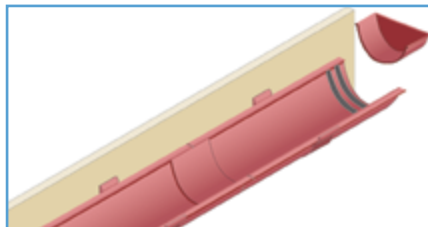

8. Running outlets and angles can be joined using the same union clip method as described in Fig.4-7. Stop ends are internally fixed in left or right hand position using the same method but without the union.

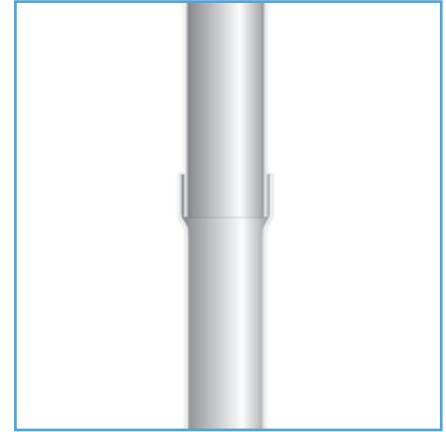
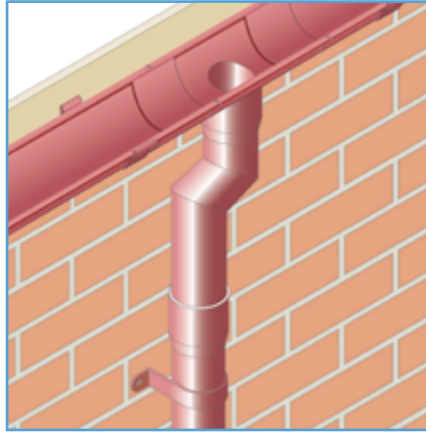
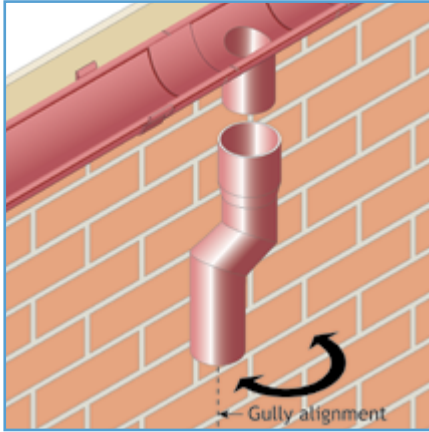

1. SnapIT pipes have an integral swaged end to allow ease of connection.

Align the pipe work with drainage position at ground level. An offset is commonly used to connect the gutter outlet to the pipe. Round pipe systems offer the flexibility of alignment, offsets can be adjusted and “swung” into alignment with the drainage position as shown.

A range of adjustable ‘two-part’ offsets are also available for flexibility on-site and ease of installation.

2. Commence installation from the gutter outlet by fitting and adjusting the one part or two-part offsets.

Check vertical plumblines positioning. Simply push-fit the swaged end of the pipe or offset over the gutter outlet spigot for a dry jointed seal.

3. SnapIT is a dry jointed pipe system, the pipes must be installed with the swage-end pointing upward.

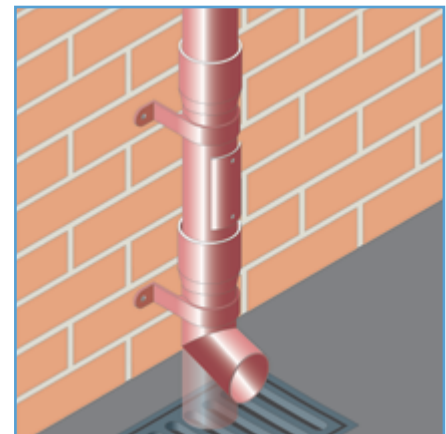
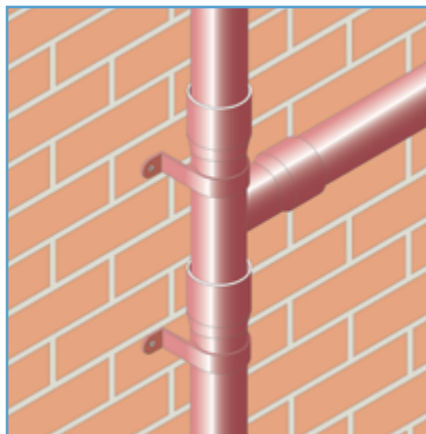
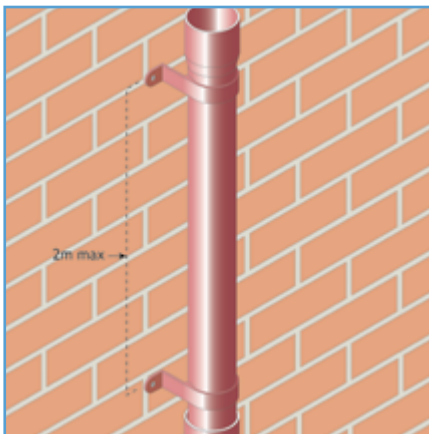

4. A pipe clip should be fixed directly underneath the pipe swage with additional clips at 2m maximum intervals. Clips to be fixed with plastic wall plugs & No12 x 2” roundhead screws SCREW20 (dependant on substrate)

5. Bends and branches are secured into the swaged pipe end.

**Note:** Ensure that the swaged end is installed to accept the direction of water flow as shown. Additional pipe clips should be used to support pipe work at junctions and changes in direction.

6. At ground level, rainwater pipes can terminate with a shoe for free discharge over a gully or be directly connected into the drainage system.

In the case of direct connections it is recommended that an access pipe fitting is included within 750mm of ground level.